



Jonoke Software Development Inc.

Suite 214, Capilano Centre
9945 50 Street
Edmonton, Alberta, Canada
T6A 0L4

Telephone (780) 448-3647
Toll-free 1-800-254-0739
Fax (780) 448-3741

www.jonoke.com

PRINT BUTLER

MediFile© Add-on Component.



THE PRINT BUTLER MAKES YOUR MediFile© SYSTEM AN
EVEN MORE USER-FRIENDLY, TIME-SAVING TOOL.

Free your workstation from print spooling with the Print Butler.

MediFile© is a paperless solution, but there are often situations that call for hard copy. Staff each waiting for their printouts to be completed can make the printer a busy spot in the office.

The Print Butler alleviates many of the complications of trying to coordinate use of one or more printers. It becomes the sole office print manager, accepting print requests from all across your network and queuing them for output. MediFile© documents take an instant to be sent from a workstation to the Print Butler, saving time and processing power for your staff computers. The Print Butler makes your MediFile© system an even more user-friendly, time-saving tool.

Print job queuing is performed on-the-fly by the Print Butler. As your various staff create letters and other documents during the day, they will regularly require a printout of some information. With a basic MediFile© setup, you may have four or five computers vying for use of a printer. Rather than tie up these workstations while the printer hurriedly accommodates each print job, the Print Butler can be the print work horse. A print task sent from a workstation is immediately sent to the Print Butler, and that workstation is done its part. The Print Butler is then in charge of that and all other print jobs, sending them sequentially to the proper printer.

Regardless of the number of print jobs already queued, the Print Butler service is always immediate and immeasurably helpful.

SEE REVERSE FOR MORE FEATURES



Jonoke
Software Development Inc.

MEDIFILE©: PRINT BUTLER ADD-ON COMPONENT

SYSTEM-WIDE ACCESS

The Print Butler serves your entire network, so that print jobs from every workstation can be output via the Butler. You can still print from a computer directly to an available printer, if need be. Meanwhile, the Print Butler is always ready to handle instant print requests, keeping workstations running quickly.

CROSS-PLATFORM

Just as MediFile© works on both Mac OS and Windows computers, the Print Butler is cross-platform. Jonoke used it's expertise with platform-independent software development to ensure the Image Butler is usable on either of these two operating systems.

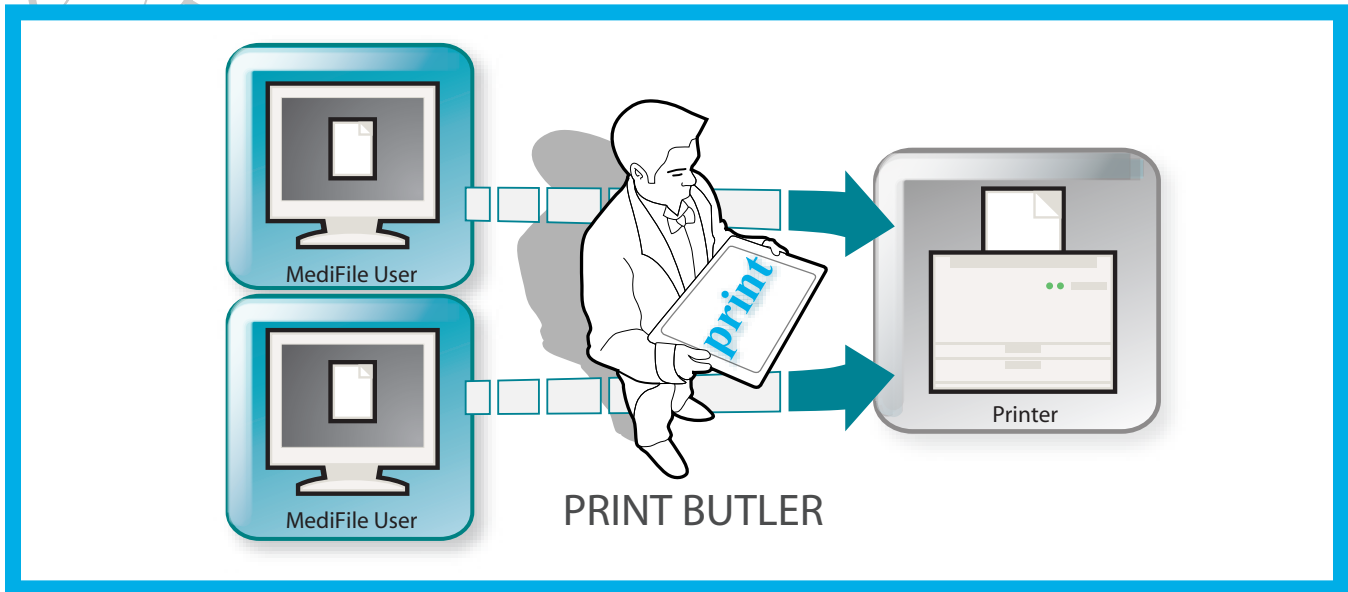
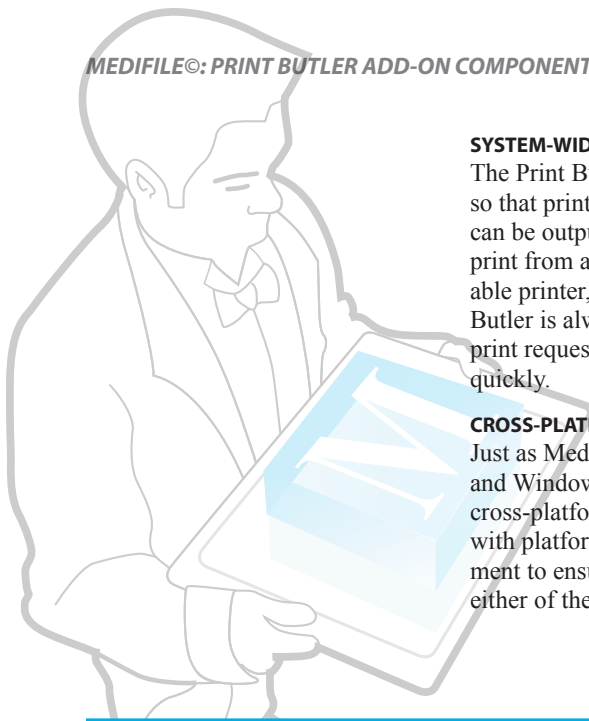

FOR MORE INFORMATION

Contact Jonoke today to find out more about getting your MediFile© system configured with the Print Butler add-on component.

Jonoke Sales
Phone 1-800-254-0739 ext. 113
Local (780) 448-3647 ext. 113
Fax (780) 448-3741
E-mail sales@jonoke.com

www.jonoke.com/MediFile/butlers